

# The Parkway



1300 S. Meridian Avenue, Oklahoma City

## Now Offered for Sale

- ❖ 96,000 sf
- ❖ 6-Story Interior Atrium
- ❖ Fully Sprinklered
- ❖ New Roof
- ❖ Close to Airport & Downtown
- ❖ Close to over a Dozen Hotels
- ❖ Close to over 25 restaurants

## \$6,750,000

- ❖ Fantastic up-side Potential
- ❖ Relatively low psf Investment
- ❖ Perfect for Owner-Occupy

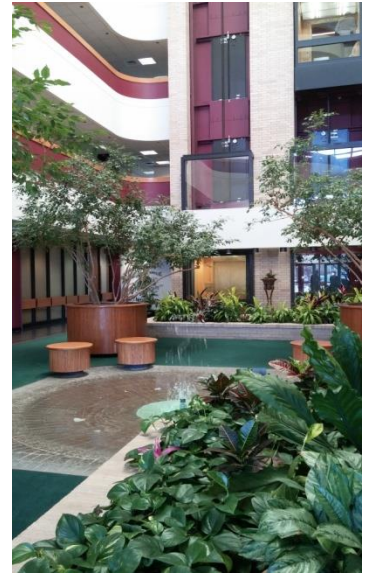

Rob Farrah

405-812-6001

[rfarrah@jdmi.com](mailto:rfarrah@jdmi.com)

# The Parkway

Aerial



**Great West-Side Location**

**Easy Access In and Out**

**Easy Access to I-40 and I-44**

**Easy Access to Airport and FAA**

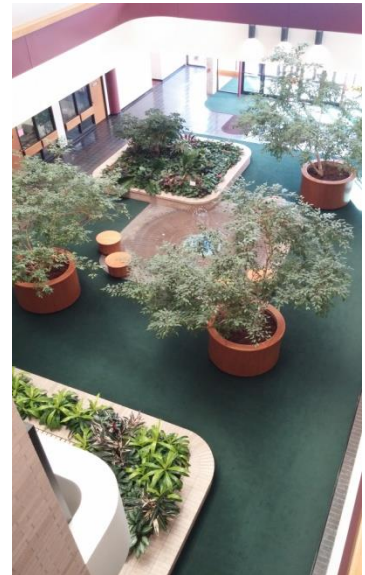

Map

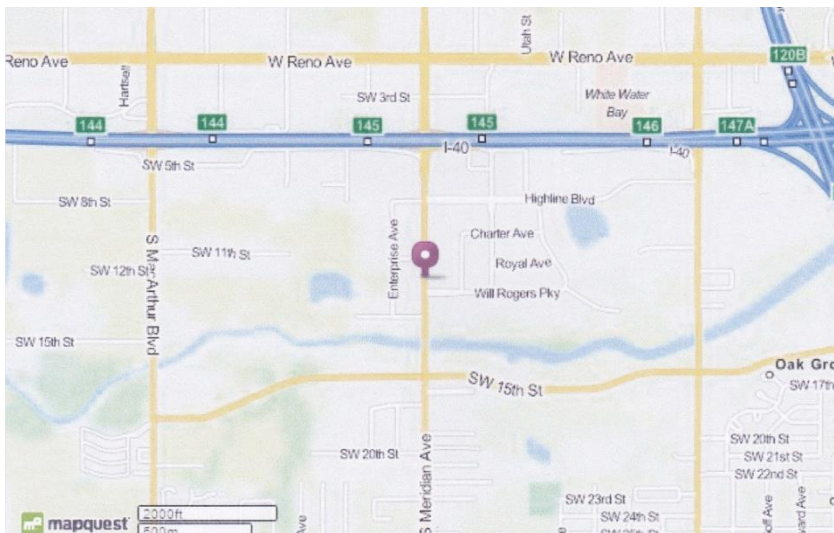

**Rob Farrah**

**405-812-6001**

**[rfarrah@jdmi.com](mailto:rfarrah@jdmi.com)**